

2014 Winneshiek County, Iowa
Horizontal Datum: **NAD 83(2011)** - Vertical Datum: **NAVD 1988**
Iowa North Zone (1401)
Iowa Regional Coordinate System Zone 2 Mason City
US Survey Feet

Point Name: **10413**

NAD 83(2011) Latitude: **N43°17'57.69183"** Longitude: **W92°04'52.41901"**

NAVD 88 Ortho Height: **1182.390sft** Ellip. Ht: **1082.951sft** **Geoid12A**

Mapping Angle: **0°57'42"** Combination Scale Factor: **0.9999544686**

Iowa North Zone (1401) Northing: **3939756.274sft** Easting: **5298940.084sft**

IaRCS Zone 2 Northing: **9849078.193sft** Easting: **12678046.798sft**

Location: Near the SE Cor of Sec 13 T98N R11W.

Designation: HOWARD COUNTY GPS CONTROL PT 2000-413

Monument Type: 5/8" dia driven aluminum rod with a 3-1/2" dia aluminum cap and permanent magnet encased in a 5" dia PVC pipe with an aluminum access cover.

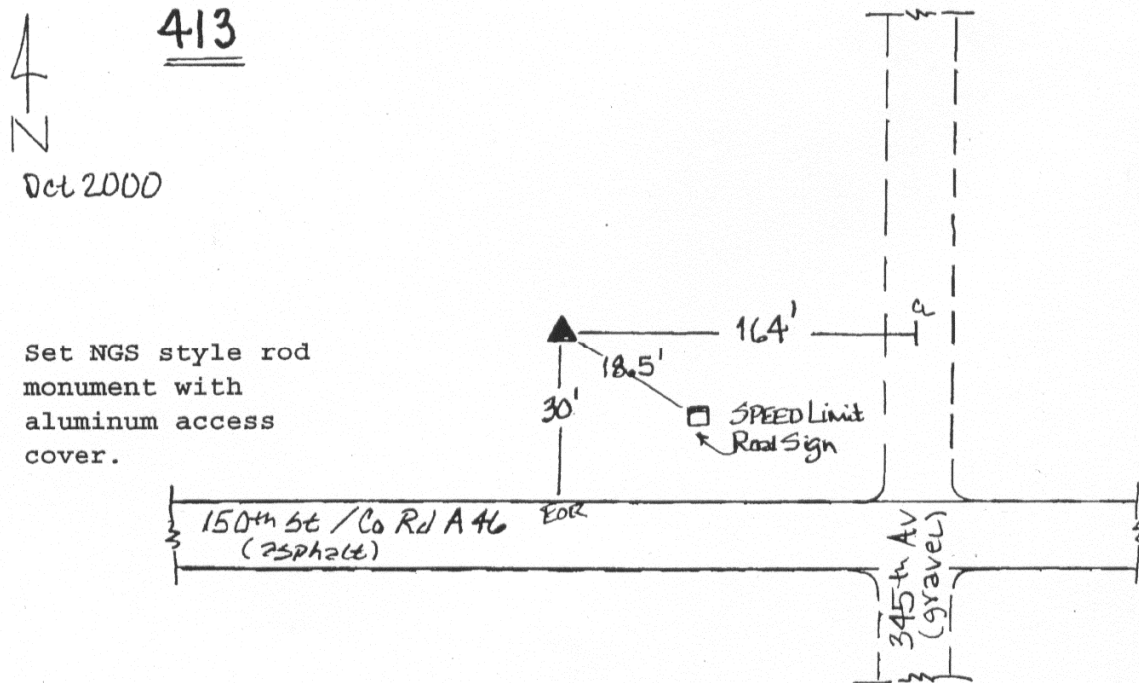

This document was prepared by DCI on February 7, 2014 for use by Winneshiek County, Iowa