

2014 Winneshiek County, Iowa

Horizontal Datum: **NAD 83(2011)** - Vertical Datum: **NAVD 1988**

Iowa North Zone (1401)

Iowa Regional Coordinate System Zone 2 Mason City

US Survey Feet

Point Name: **10415**

NAD 83(2011) Latitude: **N43°28'10.90950"** Longitude: **W92°04'48.47312"**

NAVD 88 Ortho Height: **1185.360sft** Ellip. Ht: **1085.865sft** **Geoid12A**

Mapping Angle: **0°57'44"** Combination Scale Factor: **0.9999916140**

Iowa North Zone (1401) Northing: **4001842.425sft** Easting: **5298189.063sft**

IaRCS Zone 2 Northing: **9911170.197sft** Easting: **12677841.974sft**

Location: Near the NE Cor of Sec 24 T100N R11W.

Designation: HOWARD COUNTY GPS CONTROL PT 2000-415

Monument Type: 5/8" dia driven aluminum rod with a 3-1/2" dia aluminum cap and permanent magnet encased in a 5" dia PVC pipe with an aluminum access cover.

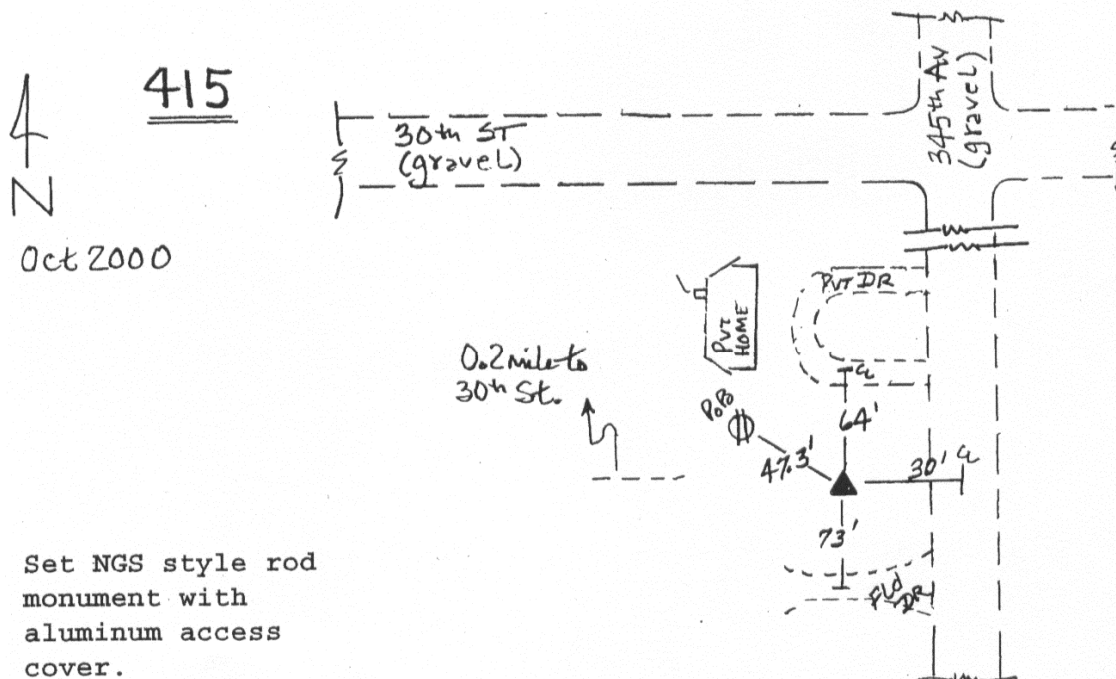

This document was prepared by DCI on February 7, 2014 for use by Winneshiek County, Iowa