

**2014 Winneshiek County, Iowa**  
Horizontal Datum: **NAD 83(2011)** - Vertical Datum: **NAVD 1988**  
Iowa North Zone (1401)  
Iowa Regional Coordinate System Zone 2 Mason City  
US Survey Feet

Point Name: **10505**

NAD 83(2011)      Latitude: **N43°30'28.13474"**      Longitude: **W91°32'00.05293"**

NAVD 88 Ortho Height: **1107.270sft**      Ellip. Ht: **1007.012sft**      **Geoid12A**

Mapping Angle: **1°19'58"**      Combination Scale Factor: **1.0000049410**

Iowa North Zone (1401)      Northing: **4018641.038sft**      Easting: **5443000.412sft**

IaRCS Zone 2      Northing: **9926698.834sft**      Easting: **12822796.559sft**

**Location:** Near the E 1/4 Cor of Sec 34 T101N R6W.

**Designation:** CBN 2nd order Vert. Station "MAUSS" - PID AC4922

**Monument Type:** Flange-encased stainless steel rod with a bullet point. Set by MNDDT with stamping "MAUSS 1995".

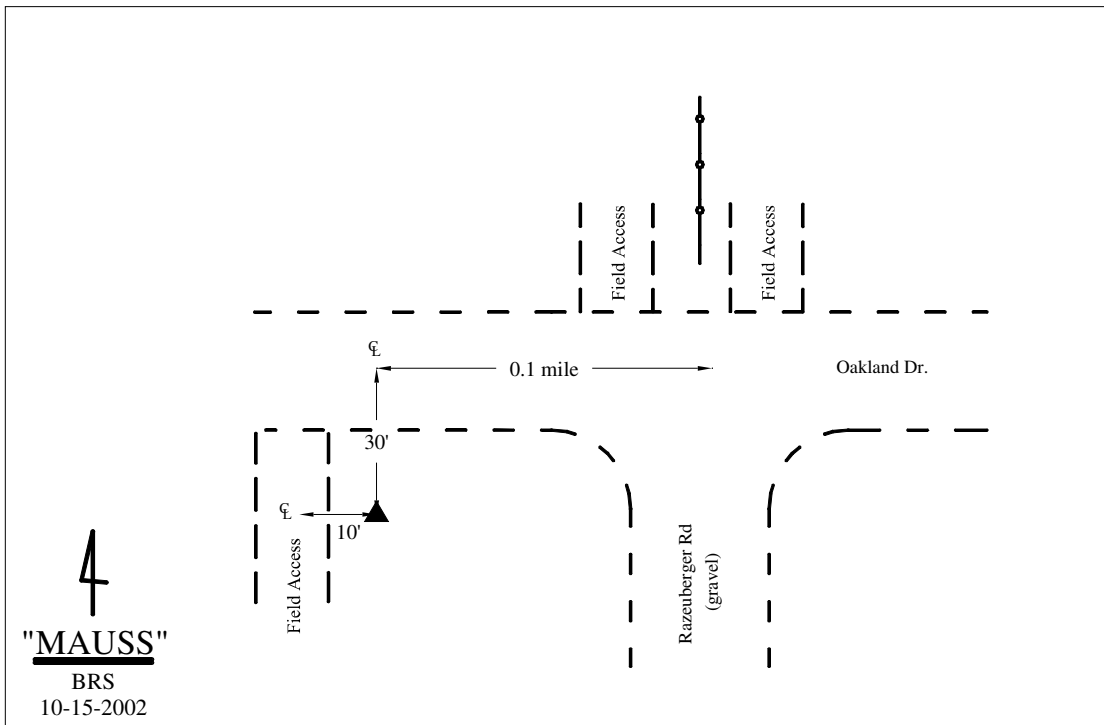

*This document was prepared by DCI on February 7, 2014 for use by Winneshiek County, Iowa*