

2014 Winneshiek County, Iowa
Horizontal Datum: **NAD 83(2011)** - Vertical Datum: **NAVD 1988**
Iowa North Zone (1401)
Iowa Regional Coordinate System Zone 2 Mason City
US Survey Feet

Point Name: **10519**

NAD 83(2011) Latitude: **N43°03'51.13827"** Longitude: **W92°13'28.24891"**

NAVD 88 Ortho Height: **1154.090sft** Ellip. Ht: **1053.350sft** **Geoid12A**

Mapping Angle: **0°51'52"** Combination Scale Factor: **0.9999190286**

Iowa North Zone (1401) Northing: **3853448.560sft** Easting: **5262092.190sft**

IaRCS Zone 2 Northing: **9763093.336sft** Easting: **12640438.226sft**

Location: In the NE 1/4 of Sec 11 T95N R12W.

Designation: CBN 2nd order Vert. Station BM "C 37" - PID OO0226

Monument Type: Bench mark disk set in the top of a concrete monument and stamped "C 37 1934".

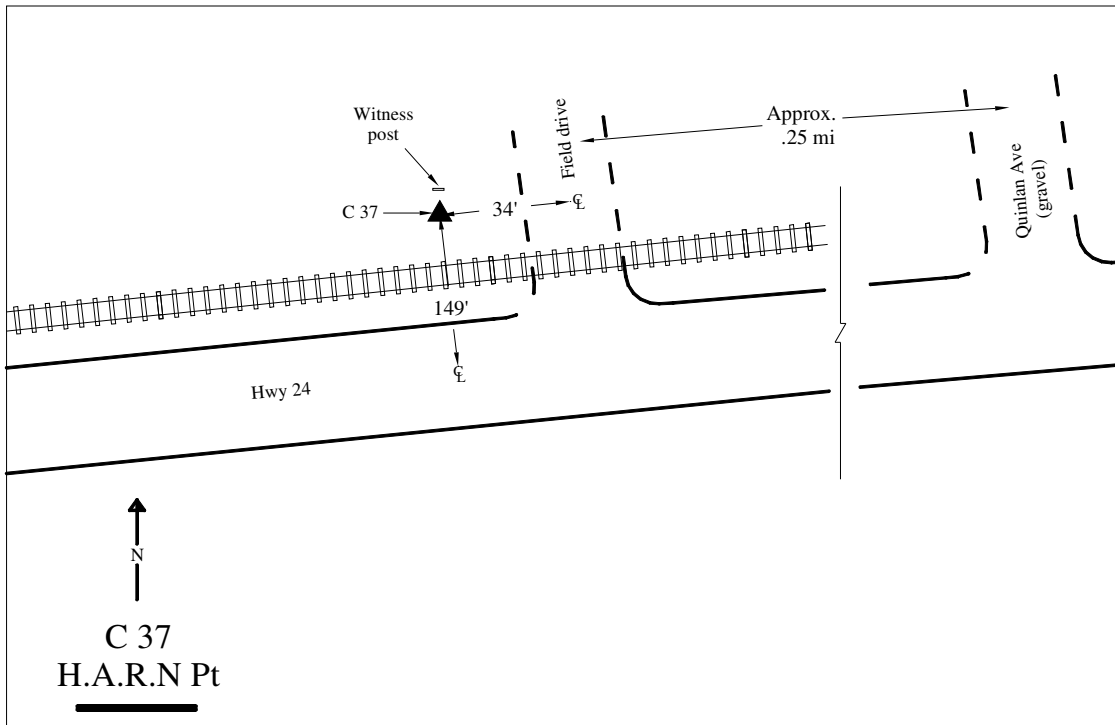

This document was prepared by DCI on February 7, 2014 for use by Winneshiek County, Iowa