

Woodbury County, Iowa

Horizontal Datum: **NAD 83(2011)** - Vertical Datum: **NAVD 1988**

Iowa State Plane North Zone (1401)

Iowa Regional Coordinate System Zone 4 Sioux City-Iowa Falls LCC

US Survey Feet

2015

Point Name: **8083**

GPS No. (1998): **8083**

Designation: 874616 2 (Set by DENI Associates in 1998)

NAD 83(NA2011) Latitude: **N42°20'38.52268"**

Longitude: **W96°11'35.30901"**

NAVD 88 Ortho Height: **1072.110sft**

Ellip. Ht: **985.080sft**

Geoid09

Iowa North Zone (1401) Northing: **3600013.783sft**

Easting: **4193309.300sft**

Mapping Angle: **-1°49'31"**

Combination Scale Factor: **0.999914232**

IaRCS Zone 4 Northing: **8533957.560sft**

Easting: **14132372.471sft**

Mapping Angle: **-00° 55' 09"**

Combination Scale Factor: **1.000003256**

Monument Type: 3-1/4" aluminum cap on aluminum rod in 6" PVC pipe with aluminum access cover.

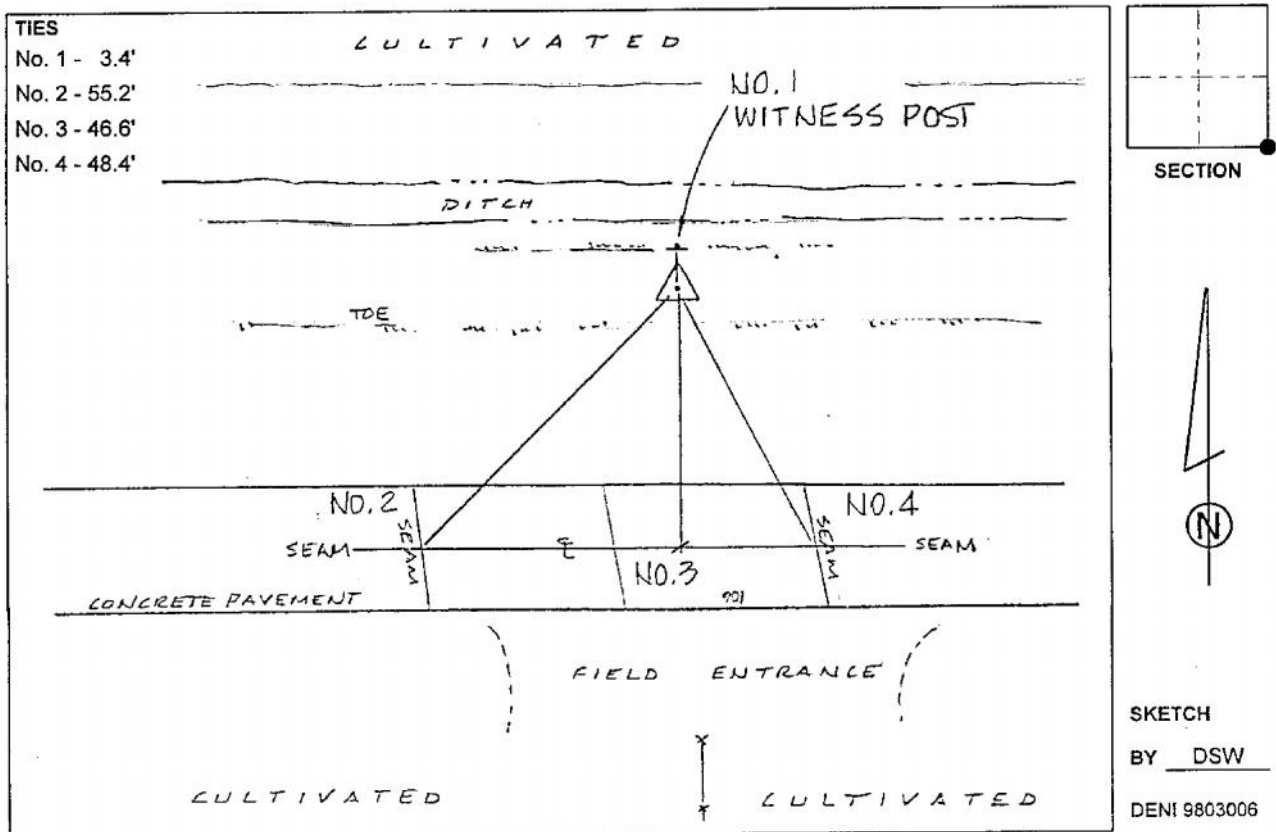

This document was prepared by Dan Corbin, Inc. on March 6, 2015 for Woodbury County, Iowa.