

**Worth County, Iowa**  
Iowa North Zone (1401)  
Horiz. Datum: NAD83(1996)  
Vert. Datum: NAVD 1988  
US Survey Feet  
**2006**

Point Name: **103**

**Designation:** G131 Winnebago Co GPS Control Monument (Set by WHKS in 2002)

Northing: **3965670.69sft** Easting: **4920743.12sft**

Orthometric Height: **1244.98sft** Ellipsoid Height: **1148.56sft** **Geoid03**

Latitude: **43°22'44.93613"N** Longitude: **93°30'06.86319"W**

Mapping Angle: **-0°00'05"** Combination Scale Factor: **0.99996769**

**Monument Type:** 5/8" x 6'-0" long aluminum rod with stamped cap and NGS style access cover.

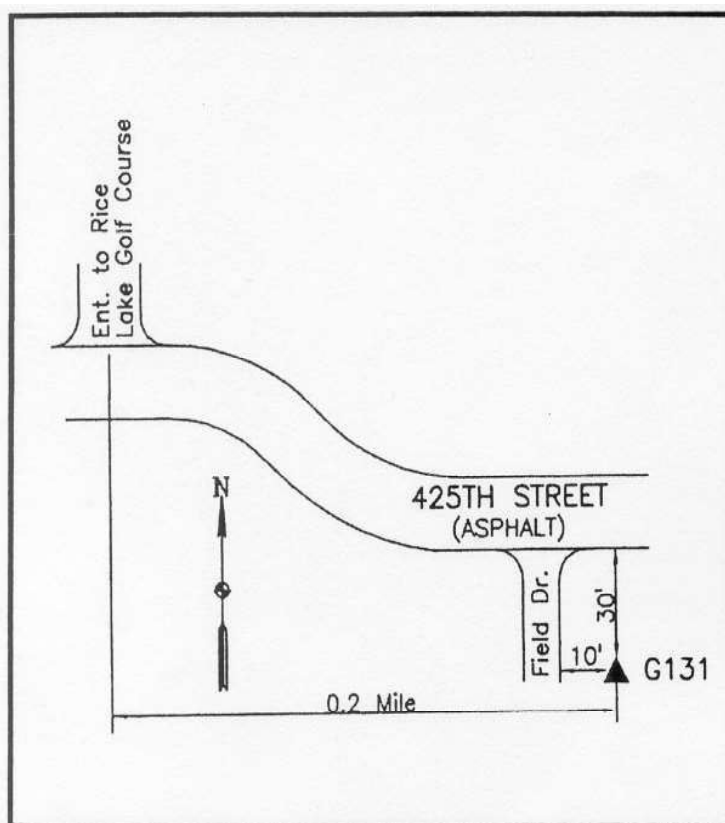

**Description:**

Placed 5/8" X 6' - 0" Long Aluminum Rod with Cap Stamped G131 and NGS Style Access Cover 2 " Deep.

**Location:**

On south side 425th Street (County Road A34) - at end of curve - 0.2± mile east of entrance to Rice Lake Golf Course (235th Avenue) east of center Section 24-T99N-R23W.