

Worth County, Iowa
Iowa North Zone (1401)
Horiz. Datum: NAD83(1996)
Vert. Datum: NAVD 1988
US Survey Feet
2006

Point Name: **105**

Designation: G113 Winnebago Co GPS Control Monument (Set by WHKS in 2002)

Northing: **3936475.97**sft Easting: **4921842.16**sft

Orthometric Height: **1221.40**sft Ellipsoid Height: **1125.34**sft **Geoid03**

Latitude: **43°17'56.59604"N**

Longitude: **93°29'51.99251"W**

Mapping Angle: **0°00'05"**

Combination Scale Factor: **0.99995239**

Monument Type: 5/8" x 6'-0" long aluminum rod with stamped cap and NGS style access cover.

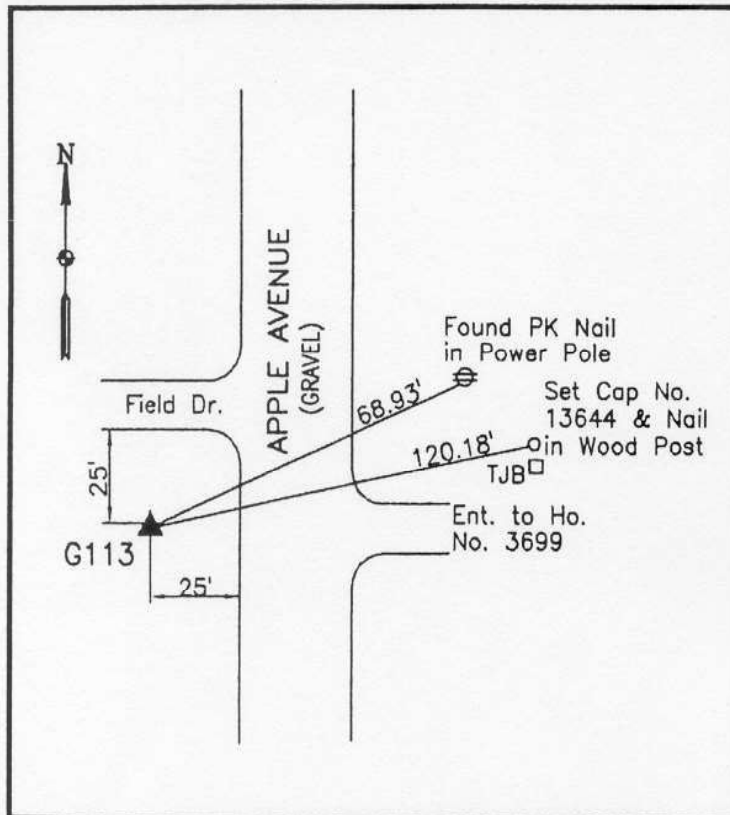

Description:

Placed 5/8" X 6' - 0" Long Aluminum Rod with Cap Stamped G113 and NGS Style Access Cover 2 " Deep.

Location:

On west side Apple Avenue - 30'± south of field entrance - near NE Corner Section 24-T98N-R23W.