

Wright County, Iowa
Horizontal Datum: **NAD 83(NA2011)** - Vertical Datum: **NAVD 1988**
Iowa State Plane North Zone (1401)
Iowa Regional Coordinate System, Zone 4, Sioux City – Iowa Falls
Units: US Survey Feet
05/27/2020

Point Name: **990022**

Designation: Wright County 0022 (set by V&K in 2004)

NAD 83(NA2011) Latitude: **N42°49'10.97929"** Longitude: **W93°29'56.13006"**
NAVD 88 Ortho Height: **1245.071sft** Ellip. Ht: **1154.587sft** Geoid18

Iowa North Zone (1401) Northing: **3761771.549sft** Easting: **4921538.407sft**
Mapping Angle: **0°00'02.6"** Combination Scale Factor: **0.9998936957**

IaRCS Zone 4 Northing: **8707197.756sft** Easting: **14858031.718sft**
Mapping Angle: **0°54'07.5"** Combination Scale Factor: **1.0000022758**

Monument Type: 5/8" diameter aluminum rod with a 2-1/2" dia. aluminum cap & permanent magnet encased in a 5" dia. PVC pipe with aluminum access cover.

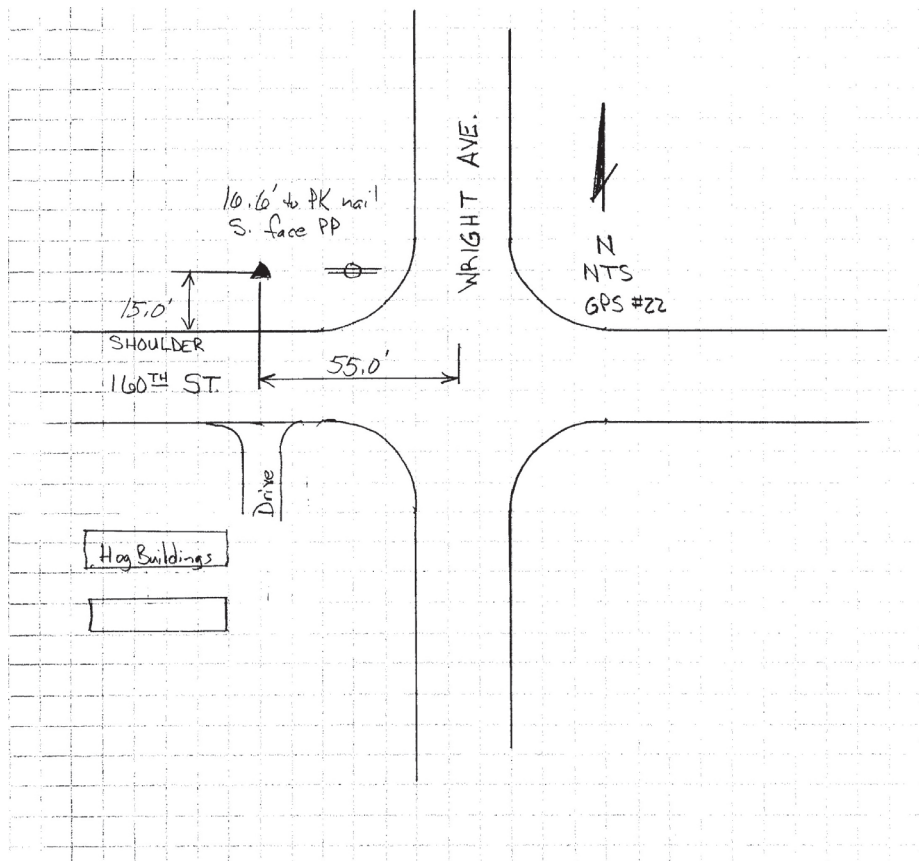

This document was prepared by Dan Corbin, Inc. on May 25th, 2021 for Wright County, Iowa.