

Wright County, Iowa
Horizontal Datum: **NAD 83(NA2011)** - Vertical Datum: **NAVD 1988**
Iowa State Plane North Zone (1401)
Iowa Regional Coordinate System, Zone 4, Sioux City – Iowa Falls
Units: US Survey Feet
05/27/2020

Point Name: **992002**

Designation: Franklin County 2004-002 (set by DCI in 2004)

NAD 83(NA2011) Latitude: **N42°39'00.57527"** Longitude: **W93°29'13.79866"**
NAVD 88 Ortho Height: **1205.825sft** Ellip. Ht: **1115.723sft** **Geoid18**

Iowa North Zone (1401) Northing: **3699978.526sft** Easting: **4924702.528sft**
Mapping Angle: **0°00'31.3"** Combination Scale Factor: **0.9998920865**

IaRCS Zone 4 Northing: **8645455.664sft** Easting: **14862167.937sft**
Mapping Angle: **0°54'36.1"** Combination Scale Factor: **0.9999937394**

Monument Type: Bernsten Top Security Rod monument with a 2-1/2" dia. domed survey cap encased in a 5" dia. PVC pipe with a NGS style aluminum access cover.

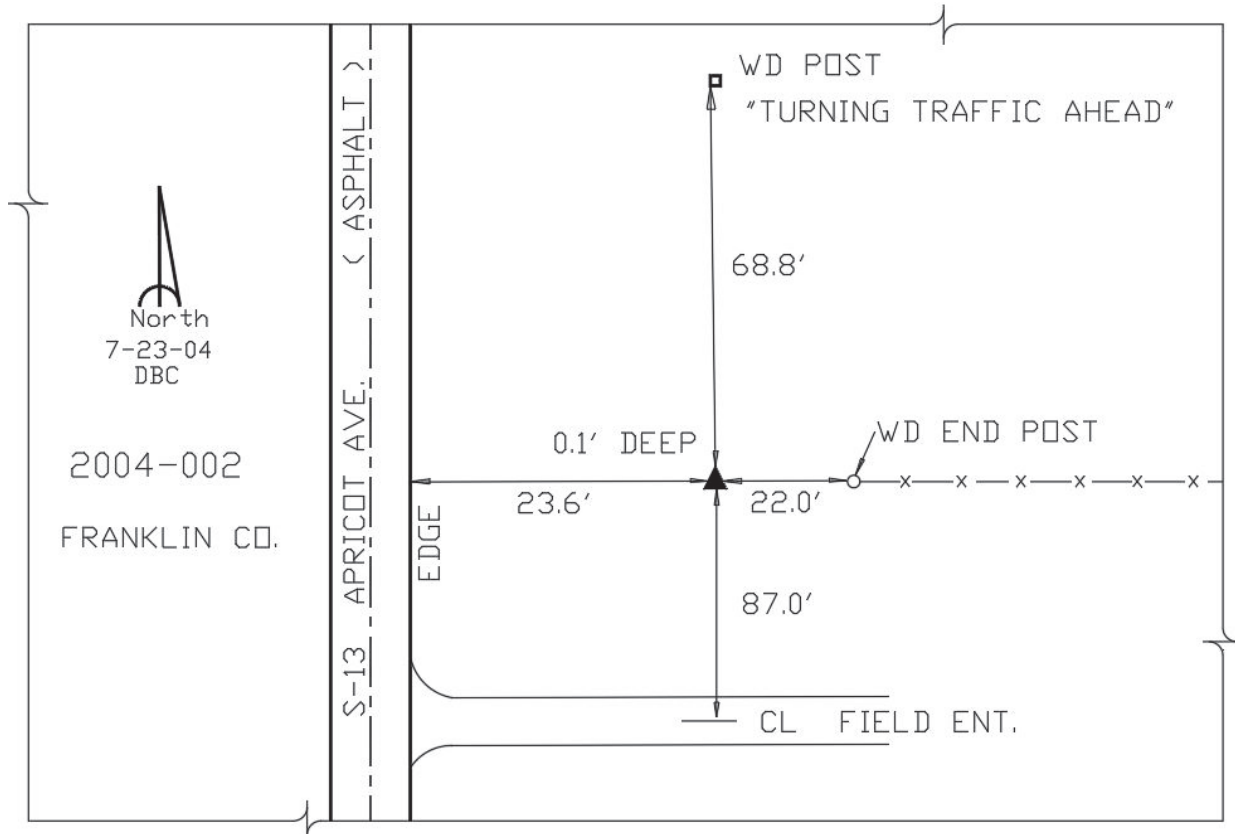

This document was prepared by Dan Corbin, Inc. on May 25th, 2021 for Wright County, Iowa.