

Wright County, Iowa
Horizontal Datum: **NAD 83(NA2011)** - Vertical Datum: **NAVD 1988**
Iowa State Plane North Zone (1401)
Iowa Regional Coordinate System, Zone 4, Sioux City – Iowa Falls
Units: US Survey Feet
05/27/2020

Point Name: **993002**

Designation: Hamilton County 2002-002 (set by ASI in 2002)

NAD 83(NA2011) Latitude: **N42°33'27.69565"** Longitude: **W93°52'24.07221"**
NAVD 88 Ortho Height: **1104.348sft** Ellip. Ht: **1015.354sft** Geoid18

Iowa North Zone (1401) Northing: **3666502.626sft** Easting: **4820661.840sft**
Mapping Angle: **-0°15'10.9"** Combination Scale Factor: **0.9998986700**

IaRCS Zone 4 Northing: **8610343.173sft** Easting: **14758656.597sft**
Mapping Angle: **0°38'56.3"** Combination Scale Factor: **0.9999965540**

Monument Type: 5/8" diameter aluminum rod with a 2-1/2" dia. aluminum cap & permanent magnet encased in a 5" dia. PVC pipe with aluminum access cover.

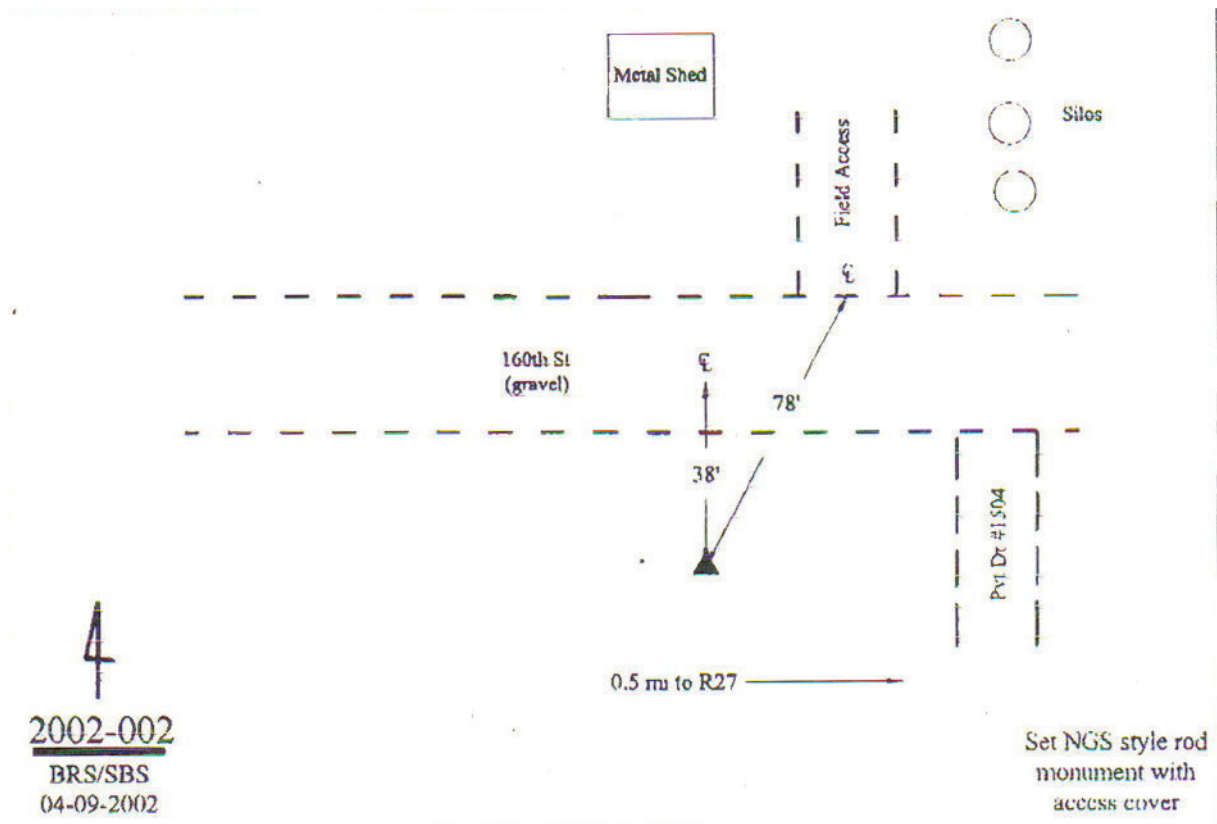

This document was prepared by Dan Corbin, Inc. on May 25th, 2021 for Wright County, Iowa.